

COMMUNITY UNITS & SETTLEMENT TYPES

SECTOR DETERMINATION			G.1		G.2		G.3		G.4		G.5					
C. U. ALLOCATION			CAS	CLD	CLD	TND	TND	RCD	TND	RCD	TND	RCD				
URBANIZATION (PARAMETRIC)	SCALE	CONFIGURATION SCALE OF C. U. (RANGE)	5 AC	20 AC	20 AC	80 AC	80 AC	160 AC	80 AC	160 AC	80 AC	160 AC	80 AC	160 AC	80 AC	160 AC
7		T. ZONES	T.1	T.1	T.1	T.1	T.1	T.1	T.1	T.1	T.1	T.1	T.1	T.1	T.1	T.1
6		T.2	T.2	T.2	T.2	T.2	T.2	T.2	T.2	T.2	T.2	T.2	T.2	T.2	T.2	T.2
5		T.3	T.3	T.3	T.3	T.3	T.3	T.3	T.3	T.3	T.3	T.3	T.3	T.3	T.3	T.3
4		T.4	T.4	T.4	T.4	T.4	T.4	T.4	T.4	T.4	T.4	T.4	T.4	T.4	T.4	T.4
3		T.5	T.5	T.5	T.5	T.5	T.5	T.5	T.5	T.5	T.5	T.5	T.5	T.5	T.5	T.5
2		T.6	T.6	T.6	T.6	T.6	T.6	T.6	T.6	T.6	T.6	T.6	T.6	T.6	T.6	T.6
1																

C. U. TYPE	SETTLEMENT TYPE
TND, RCD	CITY (LARGER) NETWORK (AT CENTER): ARMATURE: LARGE URBAN GRID; NODES: MULTIPLE, INTENSIVE; TRANSIT: GRADE SEPARATED CENTERS: REGIONAL CENTER
TND, RCD	CITY (SMALLER) NETWORK (AT CENTER): ARMATURE: MODERATE URBAN GRID; NODES: MULTIPLE, MODERATE; TRANSIT: LIGHT RAIL, STRONG BUS CENTERS: REGIONAL CENTER, METROPOLITAN CENTER
TND, RCD	URBAN TOWN NETWORK (AT CENTER): ARMATURE: MODERATE URBAN GRID; NODES: MULTIPLE, MODERATE; TRANSIT: LIGHT RAIL, STRONG BUS CENTERS: M. U. CORRIDOR, METROPOLITAN CENTER
TND, RCD	URBAN VILLAGE VARIANT: URBAN TOD NETWORK (AT CENTER): ARMATURE: MODERATE URBAN GRID; NODES: MULTIPLE, MODERATE; TRANSIT: LIGHT RAIL, STRONG BUS CENTERS: METROPOLITAN CENTER, TOWN CENTER
TND, RCD	URBAN NEIGHBORHOOD VARIANT: QUARTIER NETWORK (AT CENTER): ARMATURE: VARIED THOROUGHFARES; NODES: ONE - TWO, MODERATE; TRANSIT: MODERATE BUS CENTERS: TOWN CENTER, VILLAGE CENTER
CLD, TND	TOWN (LARGER) VARIANT: TOWN TOD NETWORK (AT CENTER): ARMATURE: VARIED THOROUGHFARES; NODES: ONE - TWO, MODERATE; TRANSIT: MODERATE BUS CENTERS: TOWN CENTER, VILLAGE CENTER
CLD, TND	TOWN (SMALLER) SYNONYM: VILLAGE NETWORK (AT CENTER): ARMATURE: LOCAL THOROUGHFARES; NODES: ONE, MINOR; TRANSIT: MINOR BUS CENTERS: VILLAGE CENTER, NEIGHBORHOOD CTR
CLD, TND	NEIGHBORHOOD NETWORK (AT CENTER): ARMATURE: LOCAL THOROUGHFARES; NODES: ONE, SMALL; TRANSIT: MINOR BUS CENTERS: NEIGHBORHOOD CTR, CONVENIENCE CTR
CAS, CLD, TND	HAMLET NETWORK (AT CENTER): ARMATURE: SMALL THOROUGHFARES; NODES: N/A CENTERS: CONVENIENCE CTR, AGRIC. CENTER
CAS	AGRICULTURAL HAMLET NETWORK (AT CENTER): ARMATURE: SMALL THOROUGHFARES; NODES: N/A CENTERS: AGRIC. CENTER, FARM STAND / CROSSROAD

MIN.		MAX.		MIN.		MAX.		MIN.		MAX.		MIN.		MAX.	
TND		TND		TND		TND		TND		TND		TND		TND	
RCD		RCD		RCD		RCD		RCD		RCD		RCD		RCD	
TND		TND		TND		TND		TND		TND		TND		TND	
RCD		RCD		RCD		RCD		RCD		RCD		RCD		RCD	
TND		TND		TND		TND		TND		TND		TND		TND	
RCD		RCD		RCD		RCD		RCD		RCD		RCD		RCD	
TND		TND		TND		TND		TND		TND		TND		TND	
RCD		RCD		RCD		RCD		RCD		RCD		RCD		RCD	
TND		TND		TND		TND		TND		TND		TND		TND	
RCD		RCD		RCD		RCD		RCD		RCD		RCD		RCD	
TND		TND		TND		TND		TND		TND		TND		TND	
RCD		RCD		RCD		RCD		RCD		RCD		RCD		RCD	
TND		TND		TND		TND		TND		TND		TND		TND	
RCD		RCD		RCD		RCD		RCD		RCD		RCD		RCD	
TND		TND		TND		TND		TND		TND		TND		TND	
RCD		RCD		RCD		RCD		RCD		RCD		RCD		RCD	
TND		TND		TND		TND		TND		TND		TND		TND	
RCD		RCD		RCD		RCD		RCD		RCD		RCD		RCD	
TND		TND		TND		TND		TND		TND		TND		TND	
RCD		RCD		RCD		RCD		RCD		RCD		RCD		RCD	
TND		TND		TND		TND		TND		TND		TND		TND	
RCD		RCD		RCD		RCD		RCD		RCD		RCD		RCD	
TND		TND		TND		TND		TND		TND		TND		TND	
RCD		RCD		RCD		RCD		RCD		RCD		RCD		RCD	
TND		TND		TND		TND		TND		TND		TND		TND	
RCD		RCD		RCD		RCD		RCD		RCD		RCD		RCD	
TND		TND		TND		TND		TND		TND		TND		TND	
RCD		RCD		RCD		RCD		RCD		RCD		RCD		RCD	
TND		TND		TND		TND		TND		TND		TND		TND	
RCD		RCD		RCD		RCD		RCD		RCD		RCD		RCD	
TND		TND		TND		TND		TND		TND		TND		TND	
RCD		RCD		RCD		RCD		RCD		RCD		RCD		RCD	
TND		TND		TND		TND		TND		TND		TND		TND	
RCD		RCD		RCD		RCD		RCD		RCD		RCD		RCD	
TND		TND		TND		TND		TND		TND		TND		TND	
RCD		RCD		RCD		RCD		RCD		RCD		RCD		RCD	
TND		TND		TND		TND		TND		TND		TND		TND	
RCD		RCD		RCD		RCD		RCD		RCD		RCD		RCD	
TND		TND		TND		TND		TND		TND		TND		TND	
RCD		RCD		RCD		RCD		RCD		RCD		RCD		RCD	
TND		TND		TND		TND		TND		TND		TND		TND	
RCD		RCD		RCD		RCD		RCD		RCD		RCD		RCD	
TND		TND		TND		TND		TND		TND		TND		TND	
RCD		RCD		RCD		RCD		RCD		RCD		RCD		RCD	
TND		TND		TND		TND		TND		TND		TND		TND	
RCD		RCD		RCD		RCD		RCD		RCD		RCD		RCD	
TND		TND		TND		TND		TND		TND		TND		TND	
RCD		RCD		RCD		RCD		RCD		RCD		RCD		RCD	
TND		TND		TND		TND		TND		TND		TND		TND	
RCD		RCD		RCD		RCD		RCD		RCD		RCD		RCD	
TND		TND		TND		TND		TND		TND		TND		TND	
RCD		RCD		RCD		RCD		RCD		RCD		RCD		RCD	
TND		TND		TND		TND		TND		TND		TND		TND	
RCD		RCD		RCD		RCD		RCD		RCD		RCD		RCD	
TND		TND		TND		TND		TND		TND		TND		TND	
RCD		RCD		RCD		RCD		RCD		RCD		RCD		RCD	
TND		TND		TND		TND		TND		TND		TND		TND	
RCD		RCD		RCD		RCD		RCD		RCD		RCD		RCD	
TND		TND		TND		TND		TND		TND		TND		TND	
RCD		RCD		RCD		RCD		RCD		RCD		RCD		RCD	
TND		TND		TND		TND		TND		TND		TND		TND	
RCD		RCD		RCD		RCD		RCD		RCD		RCD		RCD	
TND		TND		TND		TND		TND		TND		TND		TND	
RCD		RCD		RCD		RCD		RCD		RCD		RCD		RCD	
TND		TND		TND		TND		TND		TND		TND		TND	
RCD		RCD		RCD		RCD		RCD		RCD		RCD		RCD	
TND		TND		TND		TND		TND		TND		TND		TND	
RCD		RCD		RCD		RCD		RCD		RCD		RCD		RCD	
TND		TND		TND		TND		TND		TND		TND		TND	
RCD		RCD		RCD		RCD		RCD		RCD		RCD		RCD	
TND		TND		TND		TND		TND		TND		TND		TND	
RCD		RCD		RCD		RCD		RCD		RCD		RCD		RCD	
TND		TND		TND		TND		TND		TND		TND		TND	
RCD		RCD		RCD		RCD		RCD		RCD		RCD		RCD	
TND		TND		TND		TND		TND		TND		TND		TND	
RCD		RCD		RCD		RCD		RCD		RCD		RCD		RCD	
TND		TND		TND		TND		TND		TND		TND		TND	
RCD		RCD		RCD		RCD		RCD		RCD		RCD		RCD	
TND		TND		TND		TND		TND		TND		TND		TND	
RCD		RCD		RCD		RCD		RCD		RCD		RCD		RCD	
TND		TND		TND		TND		TND		TND		TND		TND	
RCD		RCD		RCD		RCD		RCD		RCD		RCD		RCD	
TND		TND		TND		TND		TND		TND		TND		TND	
RCD		RCD		RCD		RCD		RCD		RCD		RCD		RCD	
TND		TND		TND		TND		TND		TND		TND		TND	
RCD		RCD		RCD		RCD		RCD		RCD		RCD		RCD	
TND		TND		TND		TND		TND		TND		TND		TND	
RCD		RCD		RCD		RCD		RCD		RCD		RCD		RCD	
TND		TND		TND		TND		TND		TND		TND		TND	
RCD		RCD		RCD		RCD		RCD		RCD		RCD		RCD	
TND		TND		TND		TND		TND		TND		TND		TND	
RCD		RCD		RCD		RCD		RCD		RCD		RCD		RCD	
TND		TND		TND		TND		TND		TND		TND		TND	
RCD		RCD		RCD		RCD		RCD		RCD		RCD		RCD	
TND		TND		TND		TND		TND		TND		TND		TND	
RCD		RCD		RCD		RCD		RCD		RCD		RCD		RCD	
TND		TND		TND		TND		TND		TND		TND		TND	
RCD		RCD		RCD		RCD		RCD		RCD		RCD		RCD	
TND		TND		TND		TND		TND		TND		TND		TND	
RCD		RCD		RCD		RCD		RCD		RCD		RCD		RCD	
TND		TND		TND		TND		TND		TND		TND		TND	
RCD		RCD		RCD		RCD		RCD		RCD		RCD		RCD	
TND		TND</													

COMMUNITY UNIT & SETTLEMENT TYPE URBAN TOWN / R.C.D.

COMMUNITY UNITS: TND/RCD

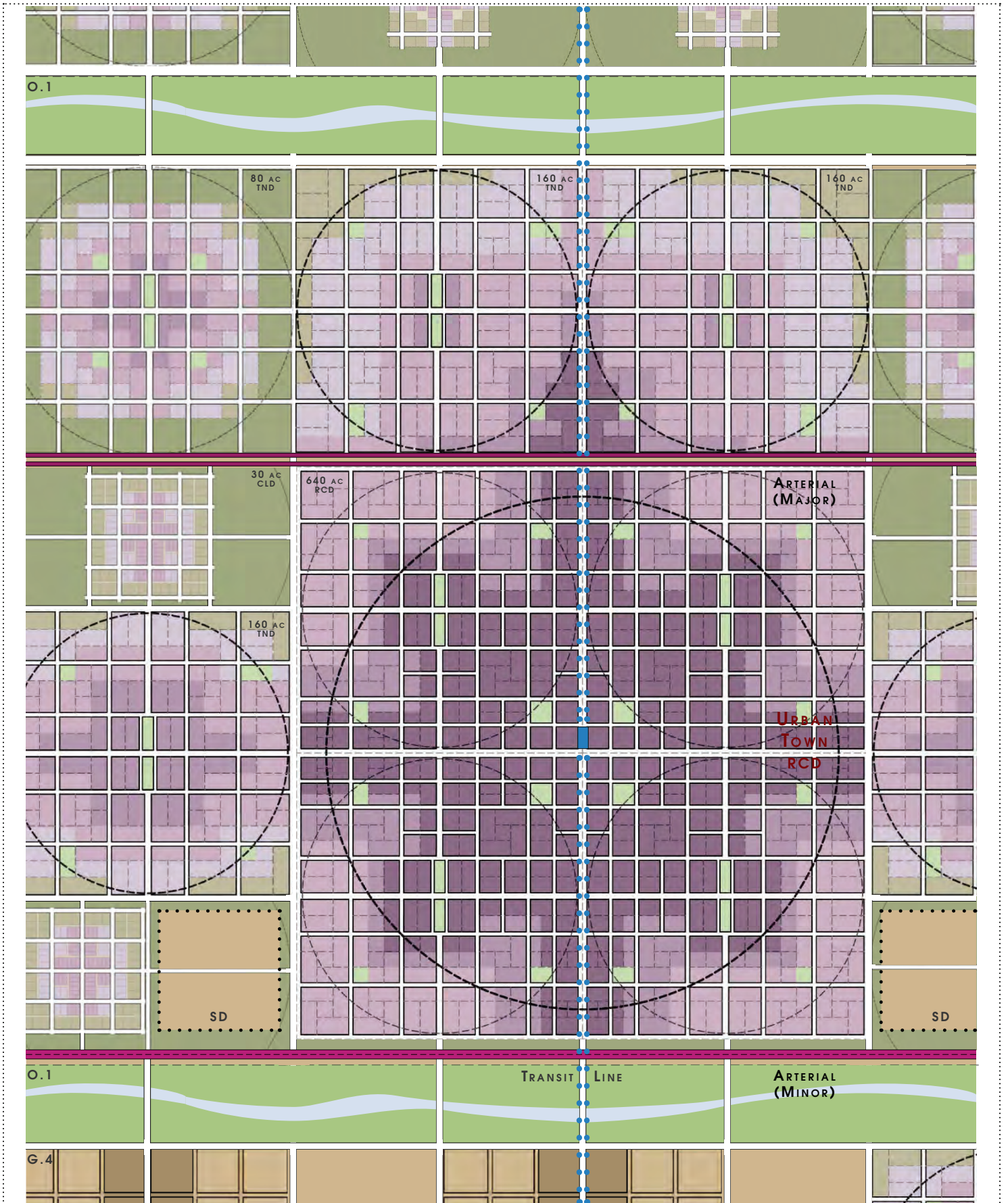

REFERENCE MEASURE: 1/4 MILE (1,320 FEET)

REFERENCE SCALE: 2 SECTIONS

0' 1,320' 2,640'

DRAWING SCALE: 1" = 1,200'

COMMUNITY UNIT & SETTLEMENT TYPE URBAN CORRIDOR/QUARTIER

COMMUNITY UNITS: TND/RCD

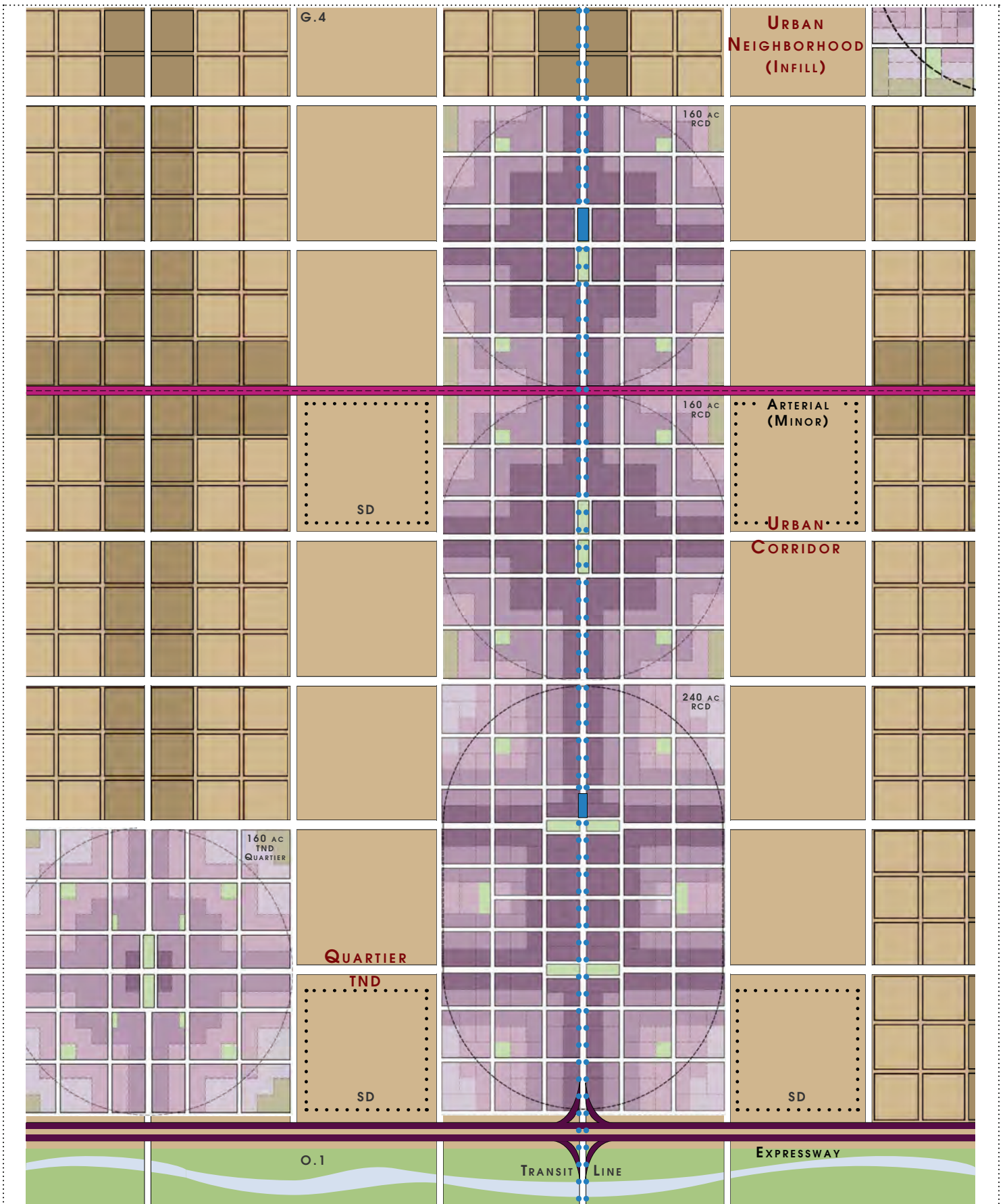

REFERENCE MEASURE: 1/4 MILE (1,320 FEET)

REFERENCE SCALE: 2 SECTIONS

0' 1,320' 2,640'

DRAWING SCALE: 1" = 1,200'

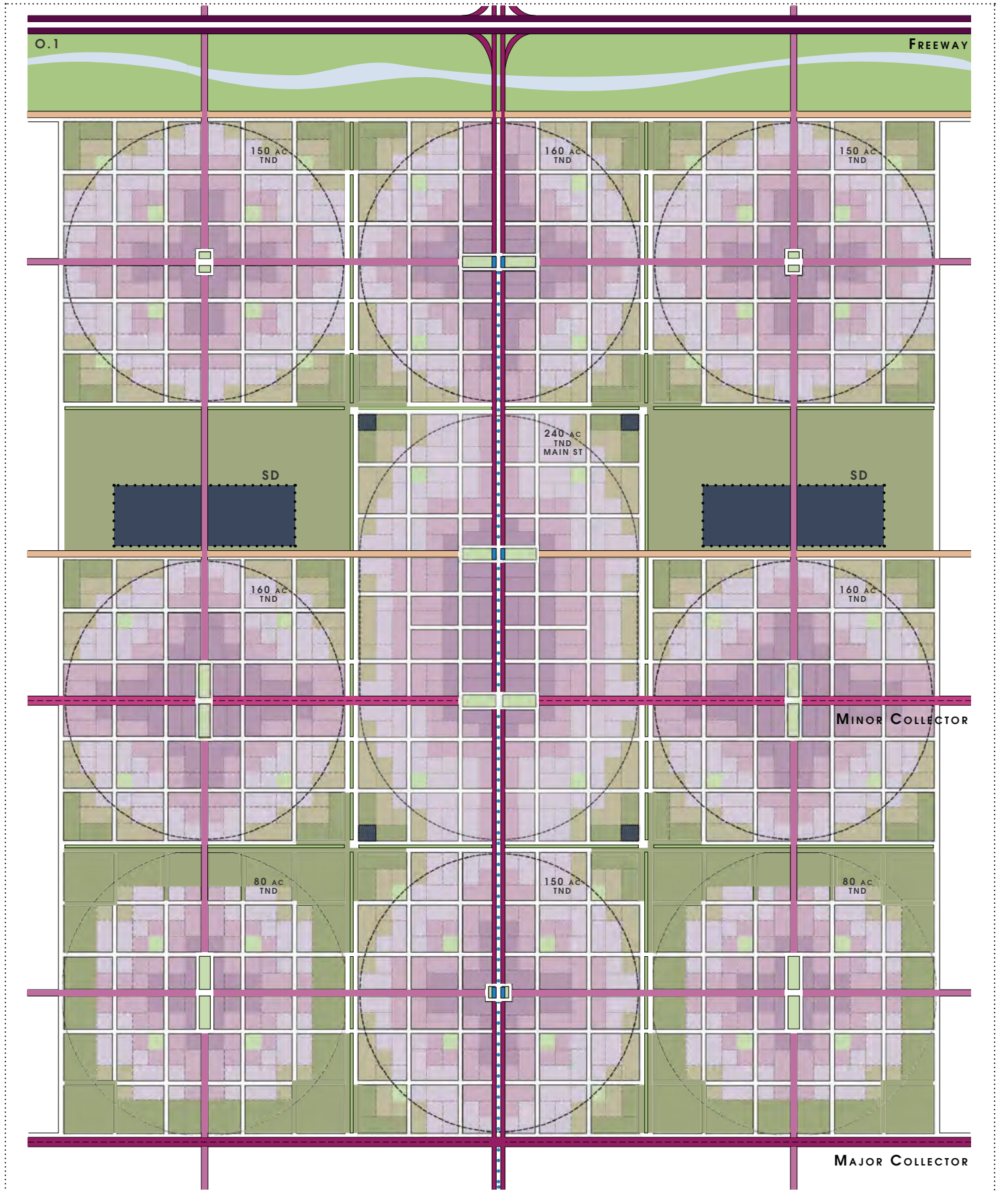

REFERENCE MEASURE: 1/4 MILE (1,320 FEET)

REFERENCE SCALE: 2 SECTIONS

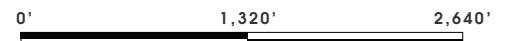

DRAWING SCALE: 1" = 1,200'

COMMUNITY UNIT & SETTLEMENT TYPE

VILLAGE

COMMUNITY UNITS: CLD/TND

TND 80 AC
CONTRIBUTING LAND 160 AC
LOT QUANTITY 520
GROSS DENSITY 3.25 : 1.00 AC

TND 160 AC
CONTRIBUTING LAND 160 AC
LOT QUANTITY 1,048
GROSS DENSITY 6.55 : 1.00 AC

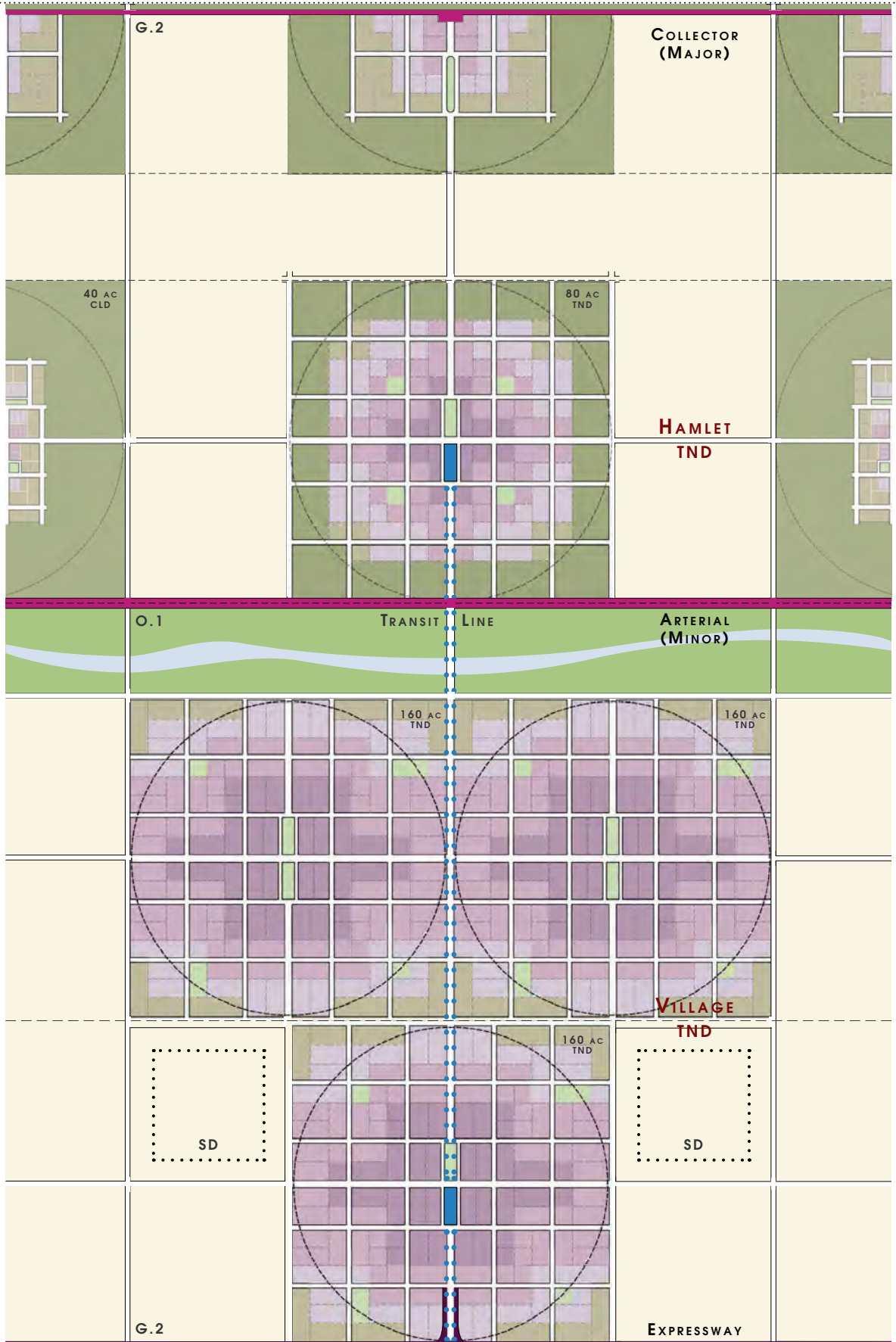

REFERENCE MEASURE: 1/4 MILE (1,320 FEET)

REFERENCE SCALE: 2 SECTIONS

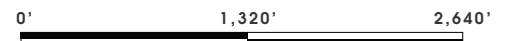

DRAWING SCALE: 1" = 1,200'

COMMUNITY UNIT & SETTLEMENT TYPE HAMLET & CLUSTER

COMMUNITY UNITS: CAS

CAS 10 AC

CONTRIBUTING LAND	320 AC
LOT QUANTITY	48
GROSS DENSITY	1: 6.67 AC

CAS 20 AC

CONTRIBUTING LAND	320 AC
LOT QUANTITY	96
GROSS DENSITY	1: 3.33 AC

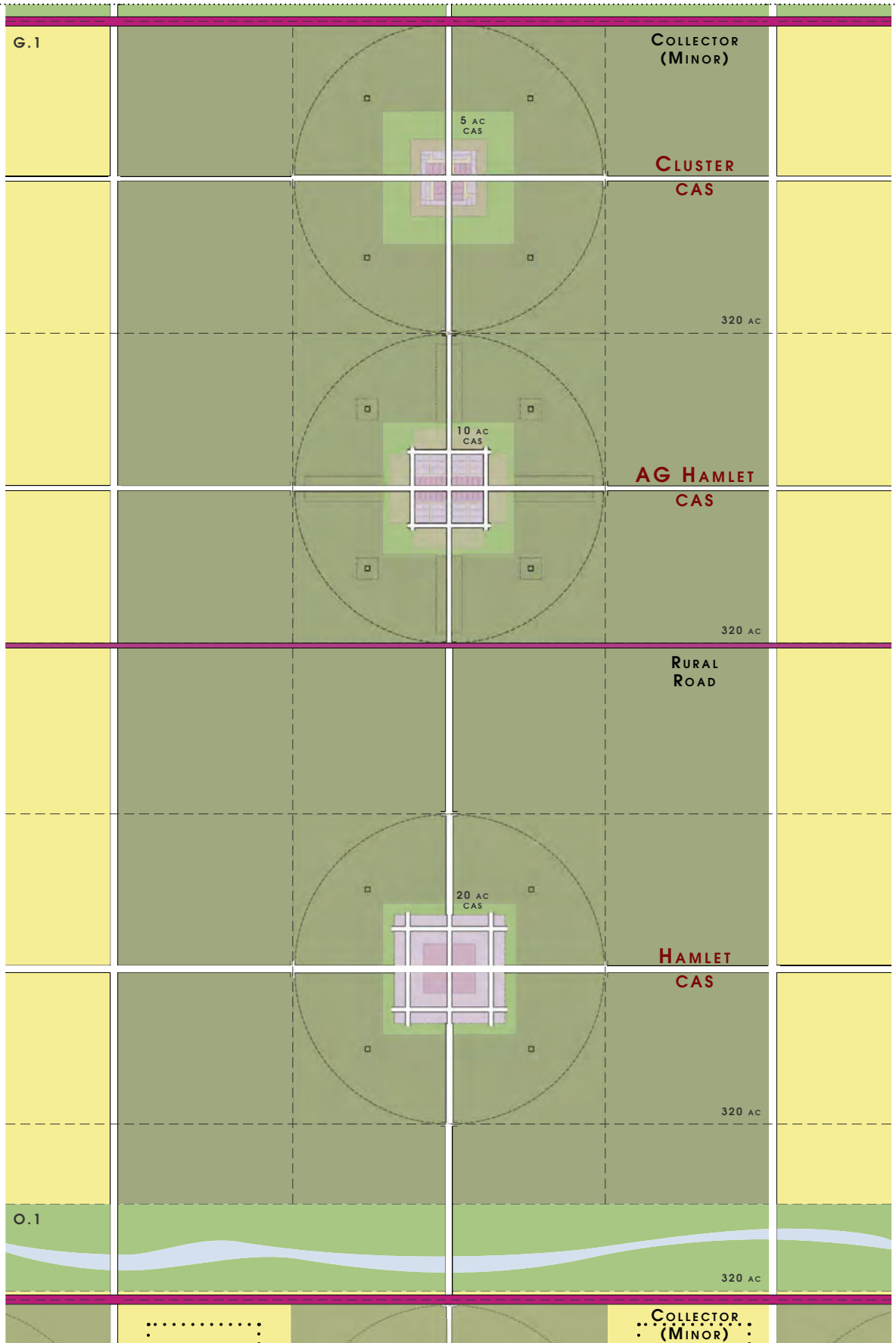

REFERENCE MEASURE: 1/4 MILE (1,320 FEET)

REFERENCE SCALE: 2 SECTIONS

0' 1,320' 2,640'

DRAWING SCALE: 1" = 1,200'